

# wrap

MY kitchen™

## Installation Guide

[www.wrapmykitchen.com](http://www.wrapmykitchen.com)

Your box contents:



- Wrap MK
- Edge banding
- Scissors
- Precision cutter
- Felt squeegee



---

## Important Notes

---

**Before you start, we suggest you to watch our installation videos from our website**  
<https://wrapmykitchen.com/en-ca/easy-installation/>

You will find among others the video for the installation on the sides of fixed boxes.

**Installation with door interiors:** If you are also covering door interiors, we particularly invite you to watch the installation video with door interiors for optimal understanding

**Replacing Handles:** If you replace your door handles and the size is different (gap between the holes), it is important to fill the unused holes before starting the installation. We suggest you use wood filler in the same color as your current doors which you will find in hardware stores. It is important to let it dry and sand the excess before applying the film.

When you have completed your makeover, please send us some **pictures of your Before / After project** so that we can share your achievement!

If you have any questions, do not hesitate to contact us at 1-855-929-WRAP (9727) or write us [info@wrapmykitchen.com](mailto:info@wrapmykitchen.com)

**Thank you for your purchase  
and good makeover!**

- 1** Before getting started, remove the cabinet doors. To do so, unscrew the hinges from the door side; you will save a lot of adjustment time afterwards.



- 2** Clean both your work area and the surfaces of the doors you are wrapping. This step is important. Do not overlook the corners and edges of the door. We recommend you use PTS (available in hardware stores) or rubbing alcohol.



- 3** Measure the height and width of the door and add 3 inches (7.5 cm) to each measure in order to cover the door edges.

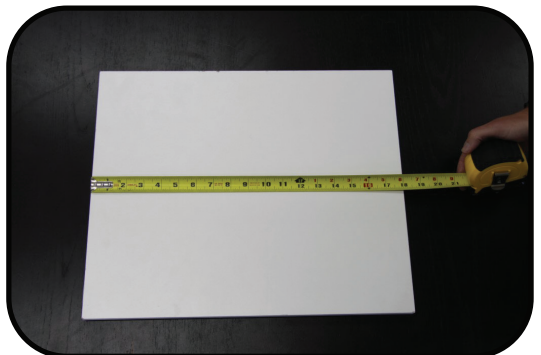

- 4** Write down the measurements on the back of the Wrap MK.

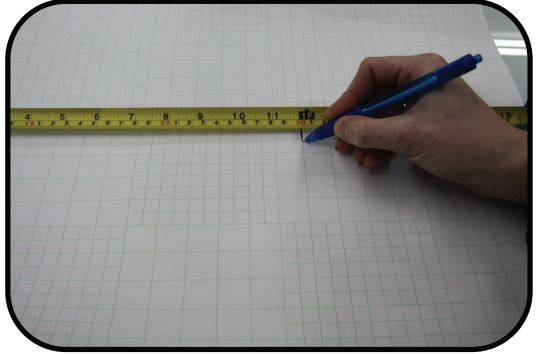

- 5** Cut using the guidelines; make sure you are cutting the right way, i.e. horizontal or vertical depending on the direction of the grain you chose to apply it.

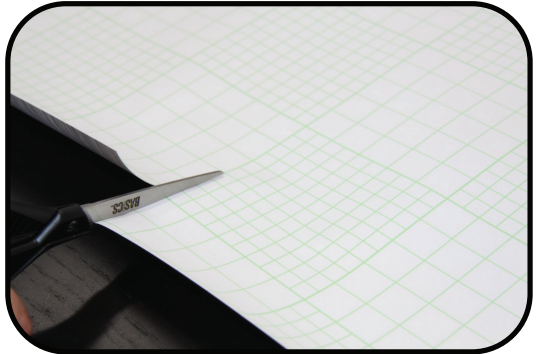

- 6** Peel a small corner of the protective paper, on the back of the Wrap MK.

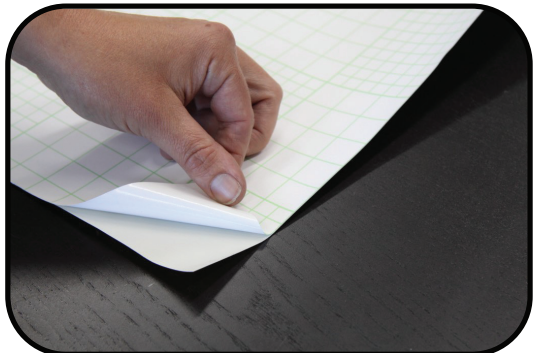

- 7** Peel off about 2 inches (4 cm) of the protective paper on the back of the Wrap MK and fold to expose only a small strip of the adhesive side.

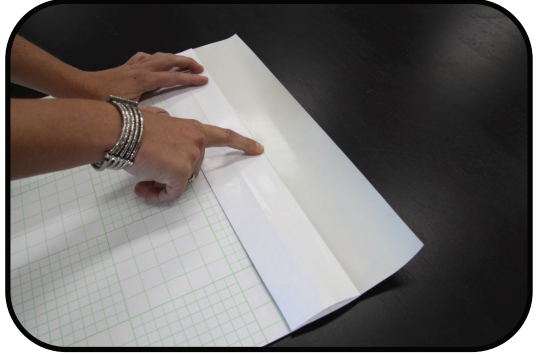

- 8** Place the exposed portion of the adhesive side at the top of the door. Leave enough of the Wrap MK to cover the door edges.



- 9** Slide your hand under the Wrap MK, gradually remove the protective paper from the adhesive. Glide the felt squeegee across the surface to eliminate air bubbles.



- 10** Once the front of the door is wrapped, turn the door over. Cut each corner at an angle a little more than 90 degrees.



- 11** Use the felt squeegee to fold the Wrap MK around the edges. Using the felt squeegee at a 45 degree angle on the edge will help the Wrap MK to mold properly.

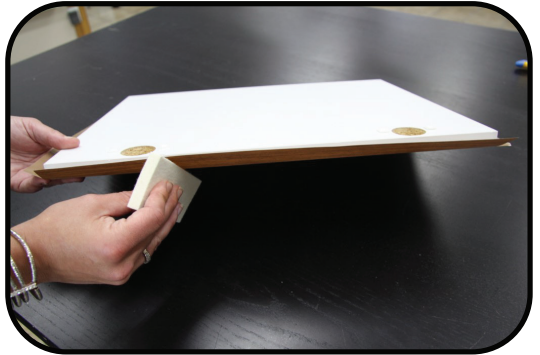

- 12** Using the precision cutter, cut the excess of the Wrap MK on the back of the door.

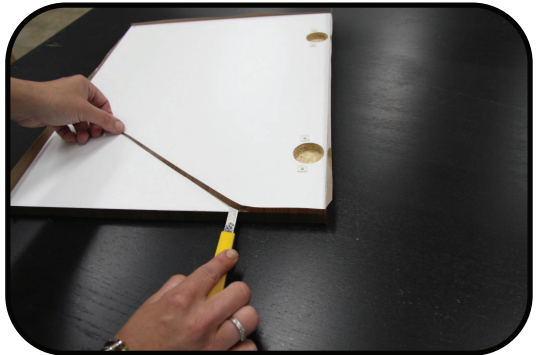

**13**

You now need to finish your door edges. Measure and cut the edge banding tape required for your door contour.

**14**

Apply the edge banding on the contour of the door starting where the edge is less visible. Do not start on a corner. The extra edge banding to be cut should be on the interior of the door.

**15**

When applying the edge banding, it is important that it does not exceed on the front panel. Leave a space of 1 mm as shown in the photo, this will prevent it from catching and peeling.

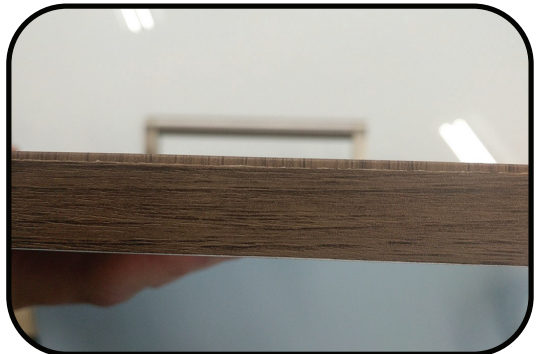

- 16** When approaching corners, pull on the edge banding and approach it as close as possible to cover the entire surface underneath.



- 17** Using the precision knife, remove the excess of edge banding on the back of the door.

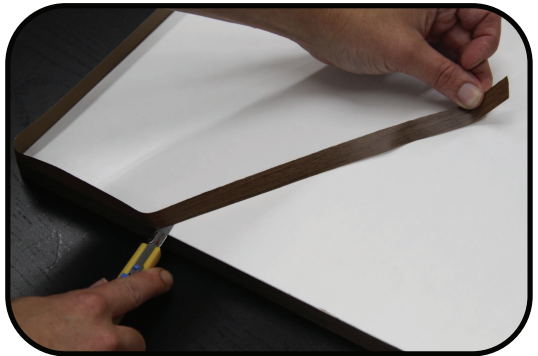

- 18** Congratulations! Feel free to contact us if you have any questions, one of our certified technicians will be happy to help you.

